

**ELECTRICAL REQUIREMENTS**

MAINS INPUT	100-240Vac, 50-60Hz ALL MODELS
SYSTEM VOLTAGE	24 Vdc
POWER CONSUMPTION WITH BOOST PUMP	52 VA
POWER CONSUMPTION WITHOUT BOOST PUMP	28 VA
FUSES	2 x T3.15 AMP
RESERVOIR LEVEL CONNECTION	JACK PLUG 3.5 mm
NOISE LEVEL	<45 dBA

**CONNECTION DETAILS.**

REF	FUNCTION	DETAILS	PRIMA 7	PRIMA 15	PRIMA 30
A	INLET- FEED WATER	8mm OD (5/16") TUBE CONNECTOR	✓	✓	✓
B	DRAIN	8mm OD (5/16") TUBE CONNECTOR	✓	✓	✓
C	OUTLET	8mm OD (5/16") TUBE CONNECTOR	✓	✓	✓
E	PRE-FILTER OUTLET	8mm OD (5/16") TUBE CONNECTOR	OPTIONAL	OPTIONAL	OPTIONAL
F	PRE-FILTER RETURN	8mm OD (5/16") TUBE CONNECTOR	OPTIONAL	OPTIONAL	OPTIONAL

**UNIT WEIGHTS**

UNIT	WEIGHT
PRIMA 7 - WITH INTERNAL BOOST PUMP	13.5KG (30.0LB)
PRIMA 7 - WITHOUT INTERNAL BOOST PUMP	11.5KG (25.0LB)
PRIMA 15 - WITH INTERNAL BOOST PUMP	14.5KG (32.0LB)
PRIMA 15 - WITHOUT INTERNAL BOOST PUMP	12.5KG (28.0LB)
PRIMA 30 - WITH INTERNAL BOOST PUMP	15.0KG (33.0LB)
PRIMA 30 - WITHOUT INTERNAL BOOST PUMP	13.0KG (29.0LB)

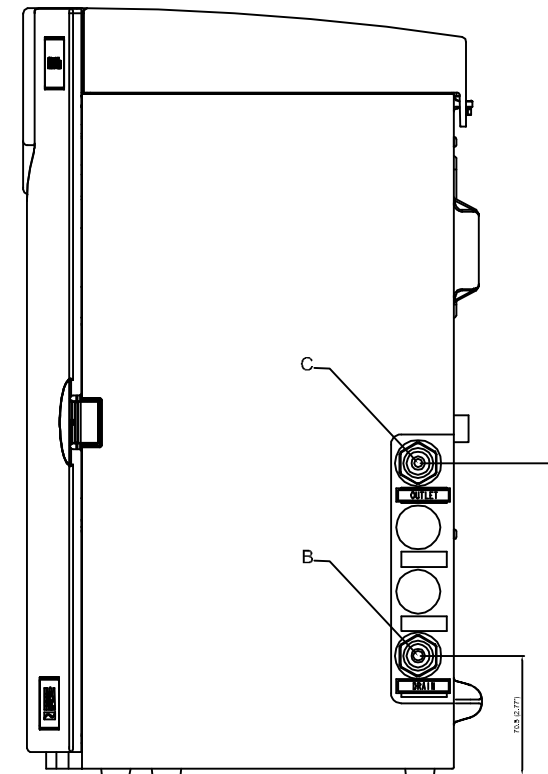
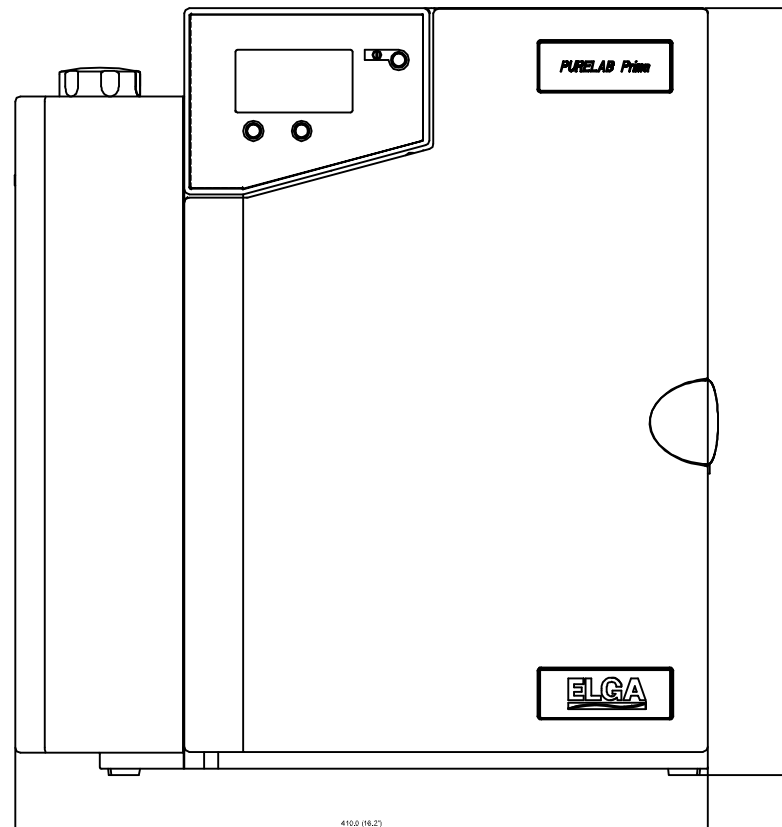
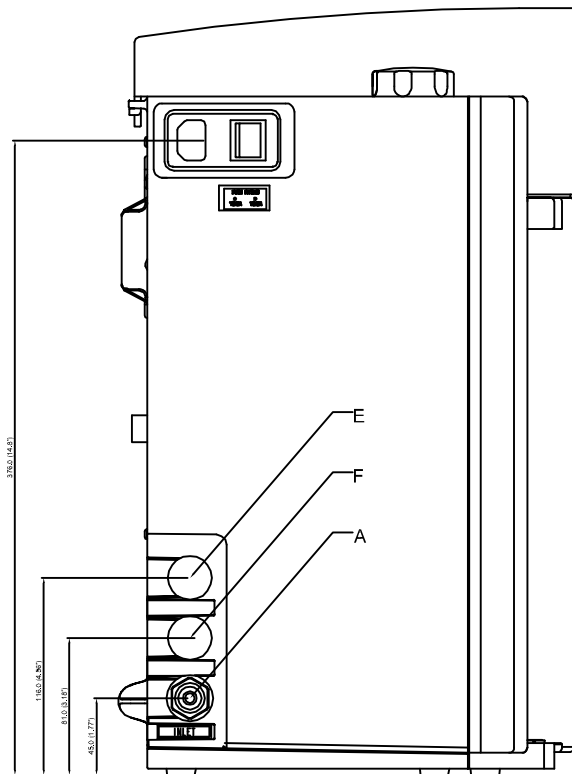

ISS.	MN/PRN/DN	ACTION	APPR'D	DATE
1	DN/E/144	JP		

**IF IN DOUBT-ASK**

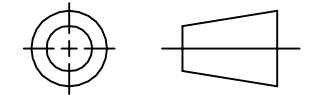

3rd ANGLE PROJECTION DO NOT SCALE

MATERIAL: N/A

FINISH: N/A

GENERAL NOTE: N/A

TOLERANCES UNLESS STATED:  
 ONE PLACE DEC. ± N/A ANGULAR ± 0.5°  
 TWO PLACE DEC. ± ALL HOLE TOLS. TO BS.4500 H11

DIMS. IN mm	SCALE	DRAWN	JP	AUG 11	DATE
			SB	AUG 11	
SIZE: A3	NTS	CHECKED	LU <th>AUG 11</th> <td></td>	AUG 11	
		APPROVED			

TITLE  
**SALES DIAGRAM  
 OUTLINE & CONN'N  
 PURELAB PRIMA  
 7/15/30 RANGE**

PART NUMBER: N/A

**ELGA**

www.elgalabwater.com

info@elgalabwater.com

ELGA is the laboratory water brand of Veolia Water Solutions & Technologies.

DRG. NO.	<b>SD_PP_001</b>	ISSUE	<b>1</b>
SHEET No.1 OF	3		

THIS DRAWING IS THE PROPERTY OF ELGA Labwater. THE DETAILS SHOWN ARE STRICTLY CONFIDENTIAL AND MUST NOT BE DISCLOSED TO ANY THIRD PARTY WITHOUT THE CONSENT OF VWS (UK) LTD.