

ISS.	MN/PRN/DN	ACTION	APPR'D	DATE
1	DN/E/144	JP		

CONNECTION & DIMENSION DETAILS.

REF	FUNCTION	DETAILS	LA611 25 LITRE	LA612 40 LITRE	LA613 75 LITRE
A	INLET	8mm OD TUBE CONNECTOR	✓	✓	✓
B	OUTLET	8mm OD TUBE CONNECTOR	✓	✓	✓
C	OVERFLOW	8mm OD TUBE CONNECTOR	✓	✓	✓
D	DISPENSE TAP	—	✓	✓	✓
E	LEVEL CONTROL	JACK SOCKET 3.5mm	✓	✓	✓
		JACK SOCKET 1/4"			
F	RESERVOIR ACCESS	80mm DIAMETER	✓	✓	✓
OPTIONAL WALL MOUNTING KIT - ELGA PART No.			LA591	LA591	LA592
OVERALL HEIGHT			500mm	600mm	755mm
DIMENSION 'A'			415mm	525mm	680mm
DIMENSION 'B'			360mm	400mm	510mm
DIMENSION 'C'			270mm	300mm	355mm
OVERALL HEIGHT - INCHES			19.68"	23.60"	29.70"
DIMENSION 'A'			16.33"	20.60"	26.77"
DIMENSION 'B'			14.17"	15.70"	20.07"
DIMENSION 'C'			10.60"	11.80"	13.97"

LEVEL CONNECTION DETAILS

DETAILS	JACK SOCKET 3.5 mm	JACK SOCKET 1/4"
PURELAB PRIMA 7/15/20	✓	
PURELAB OPTION-S 7/15	✓	
PURELAB OPTION-R 7/15	✓	
PURELAB PULSE 1 & 2	✓	
MEDICA 7/15	✓	
MEDICA-R 7/15	✓	
MEDICA-D 7/15	✓	
PURELAB ULTRA RANGE		✓

UNIT WEIGHTS

UNIT	WEIGHT (EMPTY)	WEIGHT (FULL)
LA611 (25 LITRE)	5.0KG (11.0LB)	30.0KG (66.0LB)
LA612 (40 LITRE)	8.0KG (17.6LB)	48.0KG (105.6LB)
LA613 (75 LITRE)	12.0KG (26.4LB)	87.0KG (191.0LB)

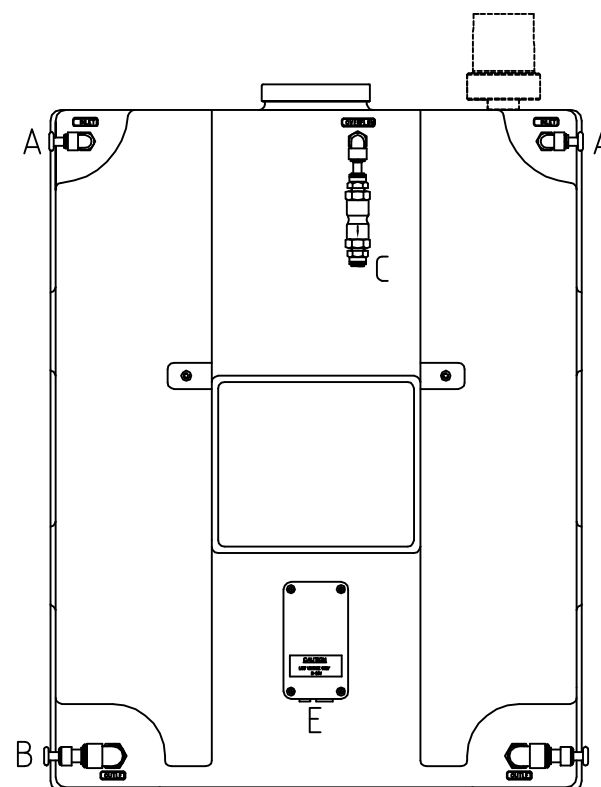
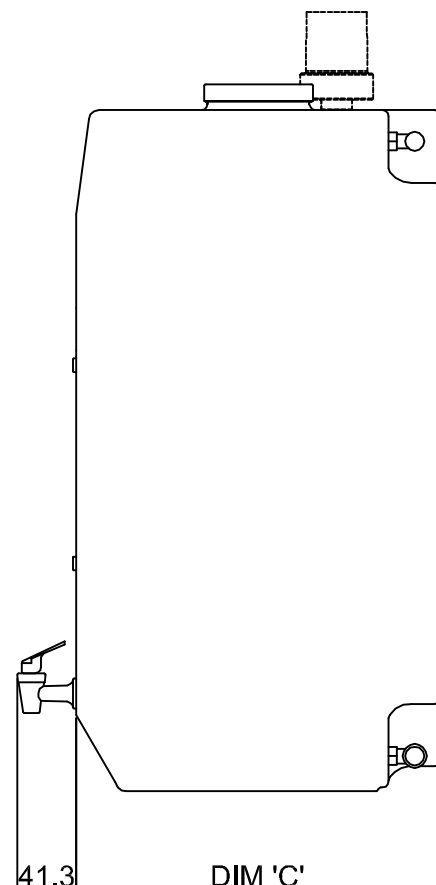
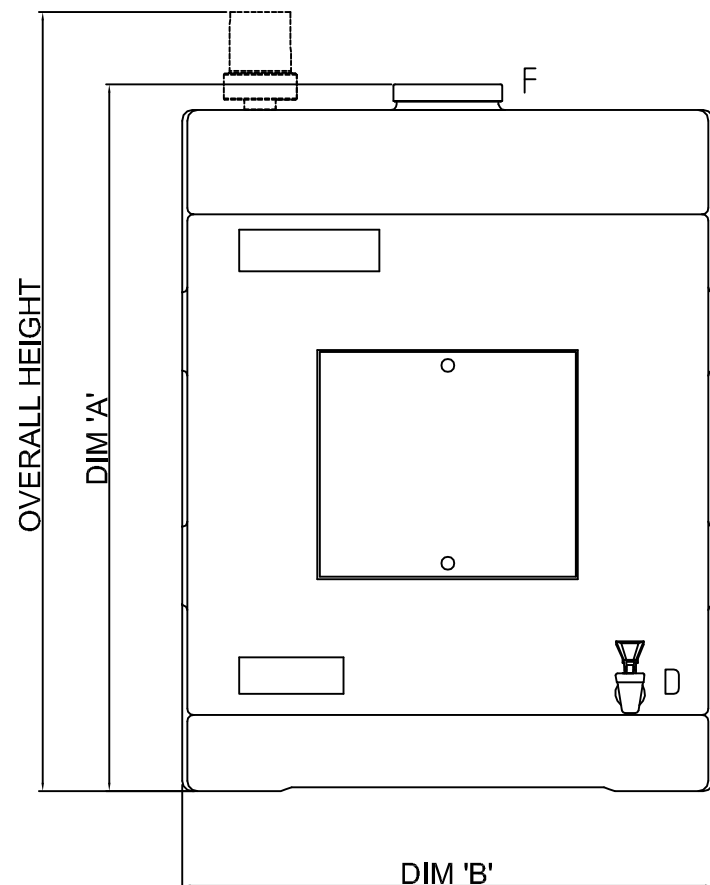

IF IN DOUBT-ASK

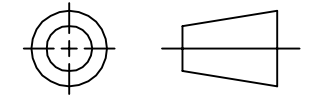

3rd ANGLE PROJECTION DO NOT SCALE

MATERIAL: N/A

FINISH: N/A

GENERAL NOTE: N/A

TOLERANCES UNLESS STATED:
 ONE PLACE DEC. ± N/A ANGULAR ± 0.5°
 TWO PLACE DEC. ± ALL HOLE TOLS. TO BS.4500 H11

DIMS. IN mm	SCALE	DRAWN	JP	AUG 11	DATE
			NTS	CHECKED	
SIZE: A3		APPROVED	LU	AUG 11	

TITLE
**SALES DIAGRAM
 OUTLINE & CONNECT'N
 LA611/LA612/LA613
 5 SWITCH RESERVOIRS**

PART NUMBER: N/A

ELGA

www.elgalabwater.com

info@elgalabwater.com

ELGA is the laboratory water brand of Veolia Water Solutions & Technologies.

DRG. NO.	SD_5SR_01	ISSUE
SHEET No.1 OF 1		1

THIS DRAWING IS THE PROPERTY OF ELGA Labwater. THE DETAILS SHOWN ARE STRICTLY CONFIDENTIAL AND MUST NOT BE DISCLOSED TO ANY THIRD PARTY WITHOUT THE CONSENT OF VWS (UK) LTD.